

SWAPN JYOT

A PROJECT BY

SWAPNAPURTI BUILDERS

SINNAR OFF:- FIRST FLOOR, KAMALA MARKET , OPP SINNAR BUS STAND, SINNAR
NASHIK OFF:- 16,THIRD FLOOR, PURNAM CENTER POINT, KANHEREWADI, NEAR CBS,NASHIK

VITTHAL WAGH- 9822841501

DIGAMBAR AVHAD- 9881400027



SITE ADD:-PLOT NO.94, S.NO 922/2, BEHIND NEW VAISHNAVI HOTEL AND SAIRAJ PETROL PUMP, PRAKASH NAGAR, SINNAR

SWAPN JYOT



A PROJECT BY
SWAPNAPURTI BUILDERS



GROUND FLOOR PLAN

9 MT. WIDE ROAD

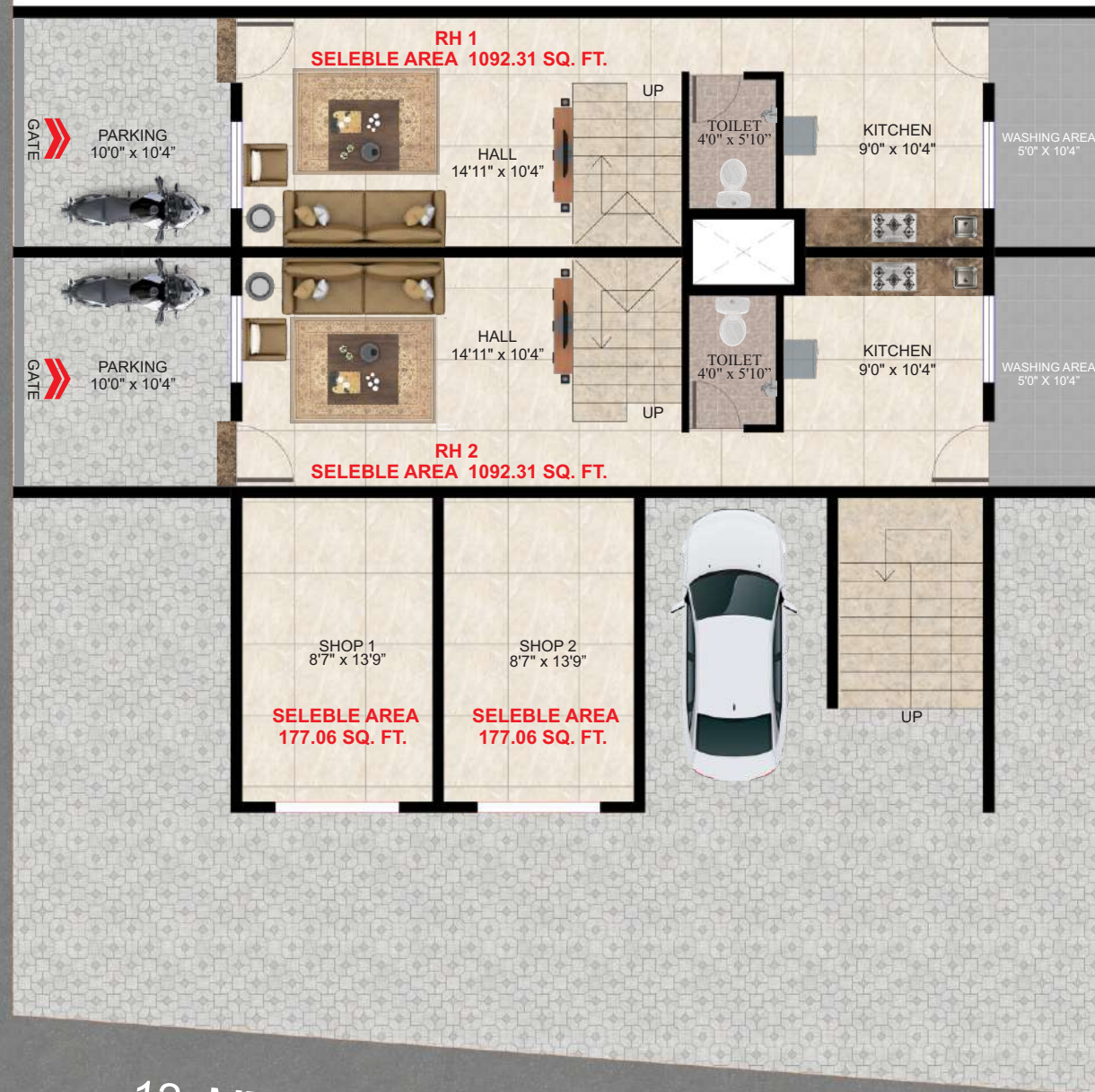

12 MT. WIDE ROAD





AMENITIES

- 📍 Earth Quik Resistant R.C.C. Framed Structure.
- 📍 External Walls 6" & Internal Walls 4" Thick Brick Work.
- 📍 External Single Coat Sandfaced Plaster & Internal Neru Finish.
- 📍 Main Door Frame in Panelling With Decorative Laminate.
- 📍 Internal Door Frames In RCC.
- 📍 ALL Door Are Water Proof Flush Door With Decorative Lamination & W.C. & Bath in PVC. Door.
- 📍 Powder Coated Three Track Aluminium Sliding Windows With Safety M.S. Grill.
- 📍 2'x2' Vitrified Tiles For All Rooms.
- 📍 W.C. Having 4FT and Bathroom Having 7FT Height Wall Tiles With Anti-skid Flooring.
- 📍 Granite Kitchen Platform With S.S. Sink & Glazed Dado Upto Lintel level.
- 📍 Concealed Plumbing PVC Pipe With ISI Grade fitting.
- 📍 Each Bathroom Having Shower.
- 📍 Concealed Electric Work With ISI Standard Wire & Switches.
- 📍 External Painting Will Be Asian Paint.
- 📍 Internal Painting In White Wash With Stainer.
- 📍 Staircase Railing. and Balcony Railing In M.S.
- 📍 Door, Window, Grills & Railling Will Be Oil Painted.
- 📍 Underground Water Tank 1000 Lit And 1000 Lit PVC Overhead water Tank To Each Unit.
- 📍 Parking With Pavers Block / Parking Tiles.
- 📍 Building Having Attractive Compound Wall.

LOCATION PLAN

